

INSTRUCTIONS GUIDE

POWER ELEVATING AND ARTICULATING CENTER MOUNT LEGREST

DESCRIPTION

Instructions for adjusting the different settings on the parallelogram-type power elevating center mount models: ADDPF-2, ADDPFHD-2 and ADDPFVHD-2.

Warning:

To minimize the risks that may occur while adjusting the center mount, it is recommended that you extend the legrest in a position that is favorable for executing the task and then, turn **OFF** the wheelchair's power using the joystick.

While performing these adjustments, it is preferable that the wheelchair be unoccupied.

REMOVING THE POWER CENTER MOUNT

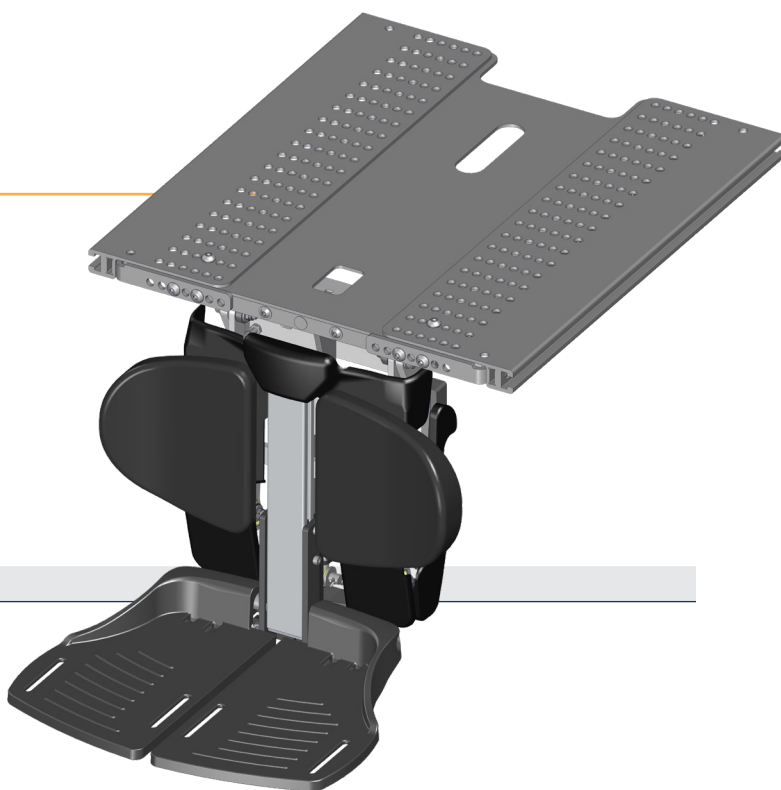
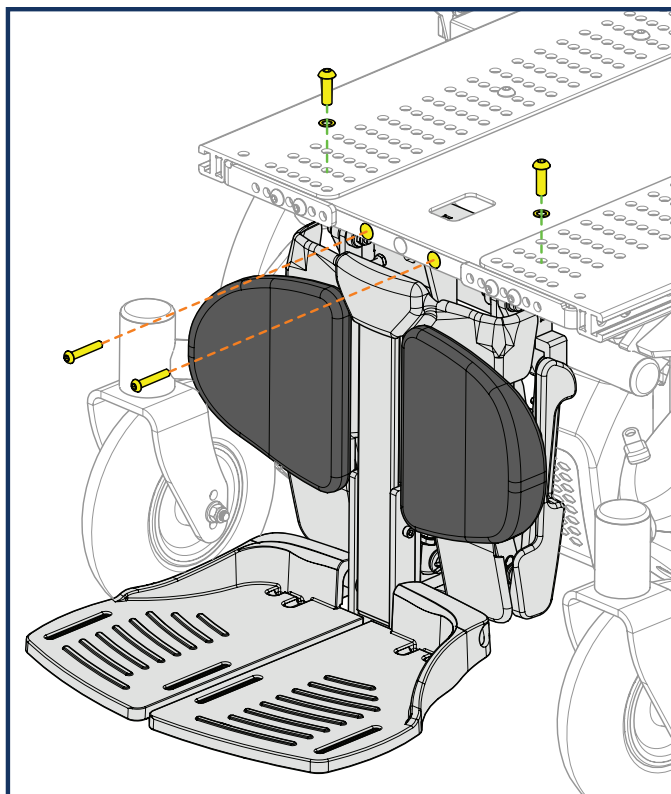

To reach the nuts easily, remove the connecting pin on the top of the actuator. This provides more room for working with tools and eases movements. First, remove the bolts that attach the legrest to the front of the seat.

Using a 5 mm Allen key and a 13 mm wrench, loosen the hex socket head nuts located under the seat. Remove the bolts.

Using a 3 mm Allen key and an 8 mm wrench, loosen the hex socket head nuts located at the front of the seat. Support the legrest before completely removing the nuts in order to prevent it from dropping. Remove the bolts.

INSTALLING THE POWER ELEVATING CENTER MOUNT

To reach the nuts easily, remove the hitch pin on the top of the actuator. This provides more room for working with tools and eases movements. Begin the installation by inserting bolts "A" that attach the legrest to the front of the seat. Locate the two holes "B" provided for this purpose, in the center of the seat.

Insert hex button head bolts "A", as shown in the diagram. Using a 3 mm Allen key and an 8 mm wrench, firmly tighten nuts "C" located behind the legrest module..

From the top of the seat pan, as shown on the diagram, insert hex button head bolts "D". Using a 5 mm Allen key and a 13 mm wrench, firmly tighten nuts "E" located under the seat pan.

Reinsert the actuator's hitch pin into the hole and reconnect the actuator's wire to the plug located under the seat.

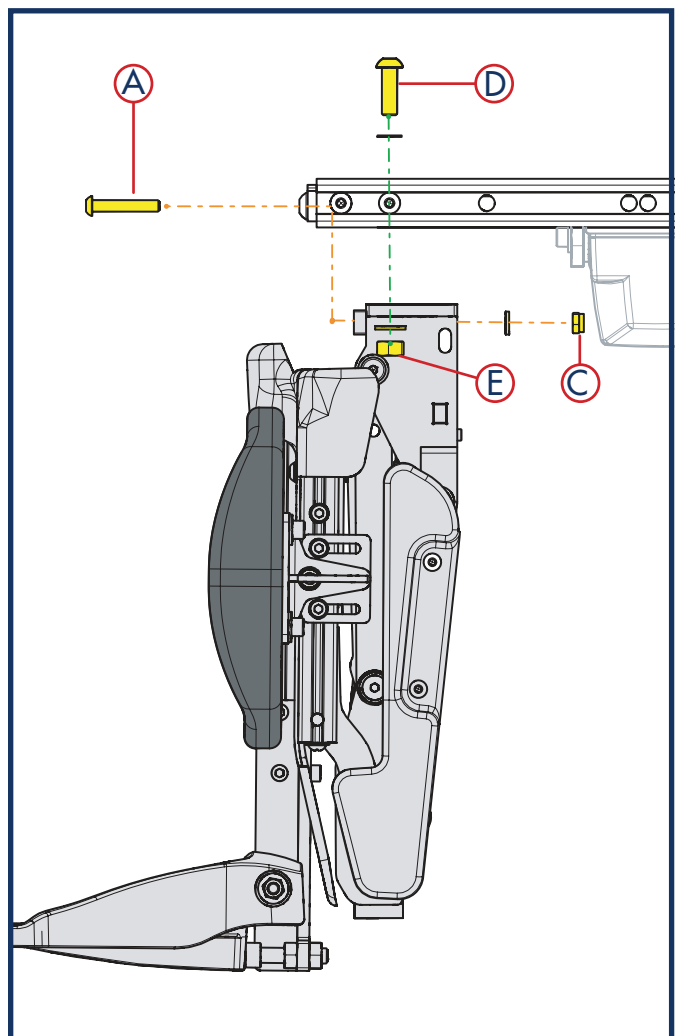
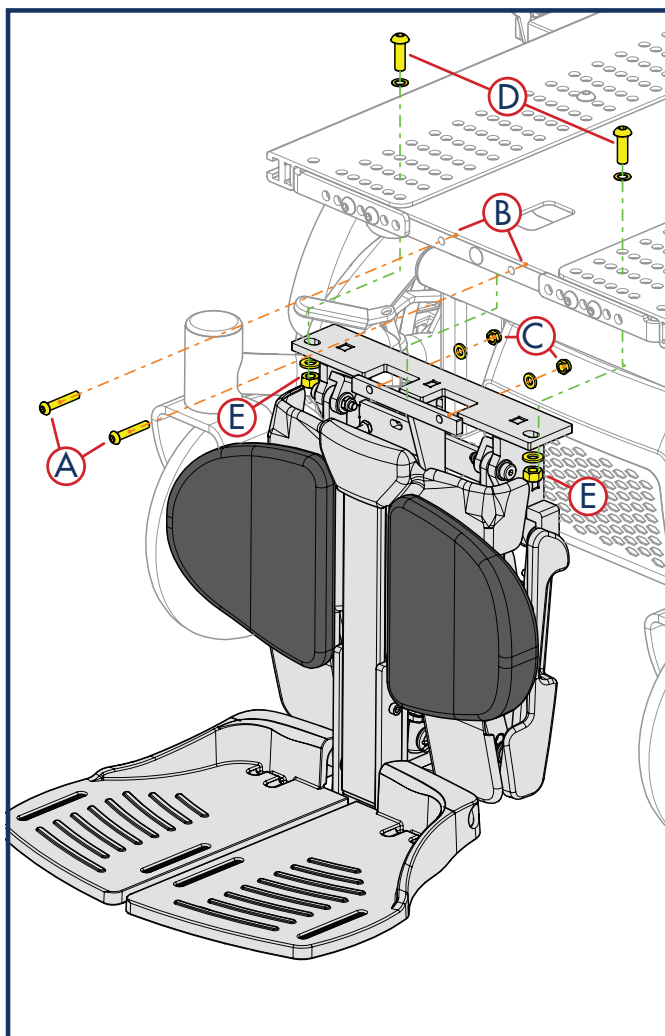

ADJUSTING THE ANGLE ON SPLIT FOOTPLATES

Adjustment is the same on both left and right sides.

Using a 13 mm wrench, loosen nut "C" while holding hex socket head bolt "A" with a 6 mm Allen key. To increase the angle of the footplate, screw nut "B". To decrease the angle, unscrew nut "B". When the desired angle is obtained, tighten bolt "A" and nut "C".

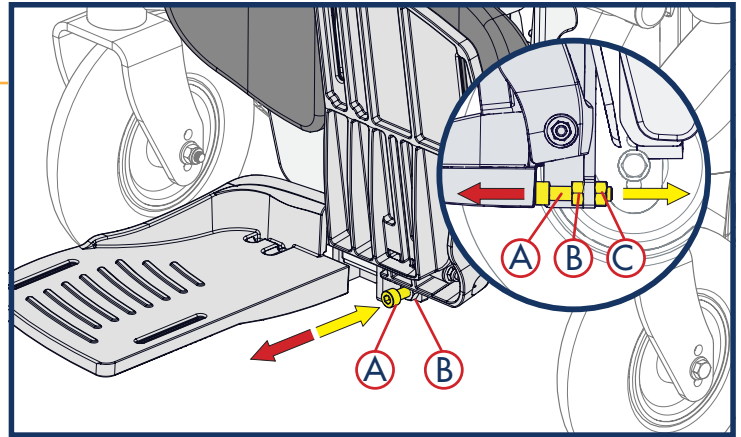

ADJUSTING THE HEIGHT ON SPLIT FOOTPLATES

Adjustment is the same on both left and right sides.

Using a 4 mm Allen key, loosen the four hex socket head bolts "D", two are located on the sides and two in the back. Adjust the footplate at the desired height and tighten the four bolts "D" moderately.

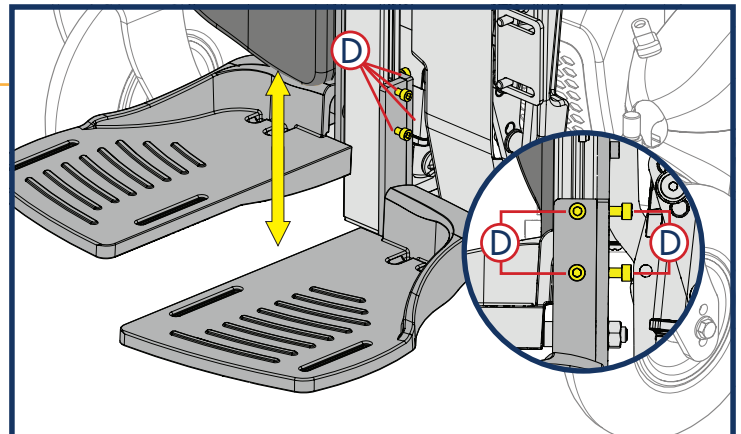

ADJUSTING THE HEIGHT ON A ONE-PIECE FOOT PLATFORM

Using a 4 mm Allen key, loosen hex socket head bolts "E", two are located on each side. Adjust the foot platform at the desired height and tighten the four bolts "E" moderately.

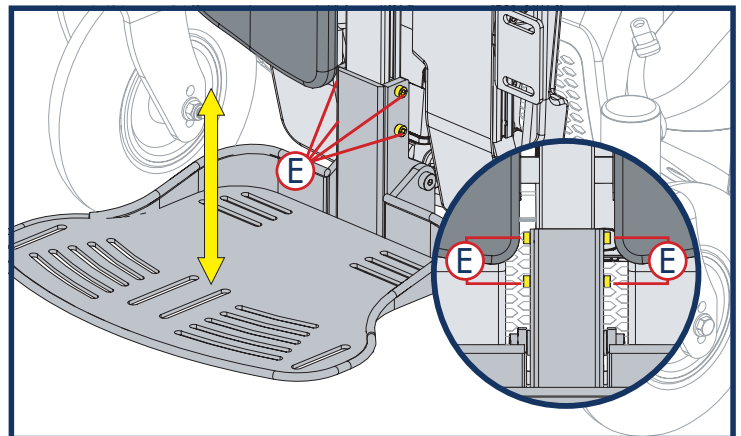

ADJUSTING THE CALF SUPPORTS

Adjustment is the same on both left and right sides.

LATERAL ADJUSTMENT

Using a 4 mm Allen key, loosen the two hex socket head bolts "A" located directly behind the calf support. Adjust the calf support at the desired width and tighten both bolts "A" moderately.

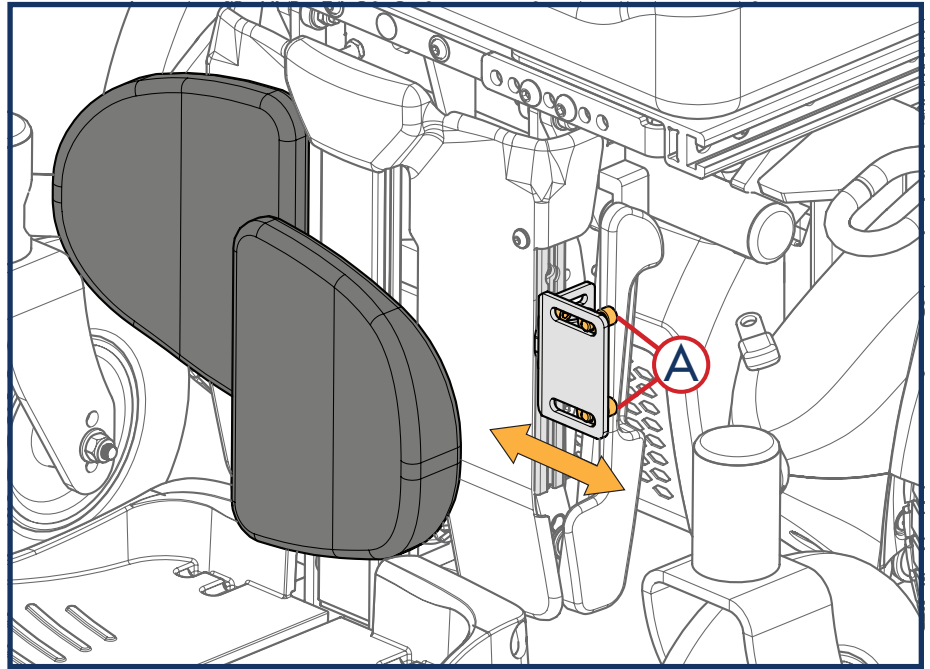
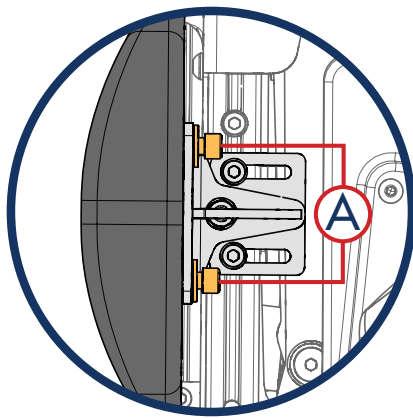

Adjustment is the same on both left and right sides.

HEIGHT AND DEPTH ADJUSTMENTS

Using a 4 mm Allen key, loosen the two hex socket head bolts "B" located along the central axis. Adjust the calf support at the desired height and depth, then tighten both bolts "B" moderately.

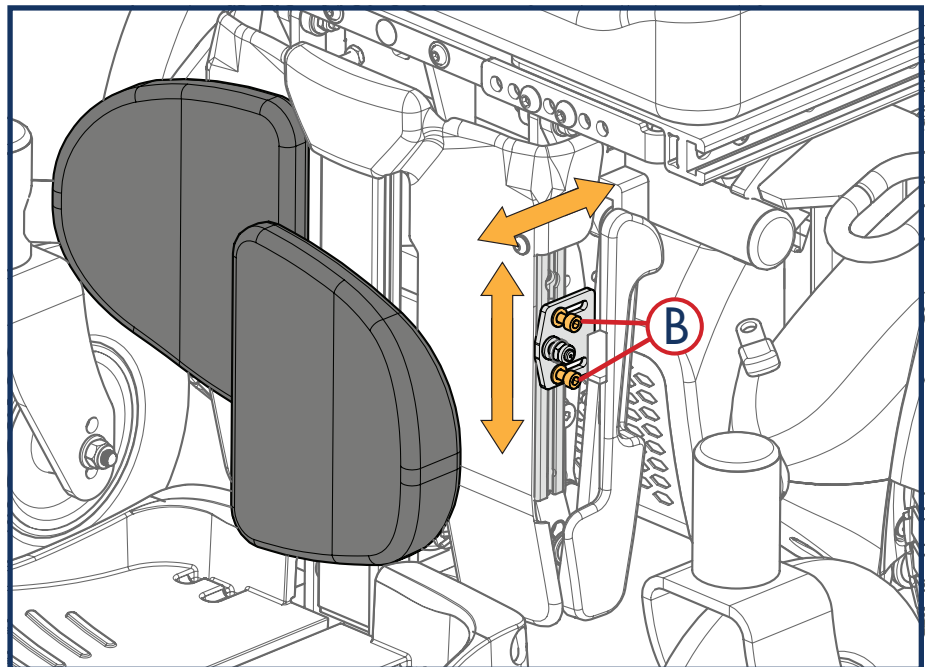
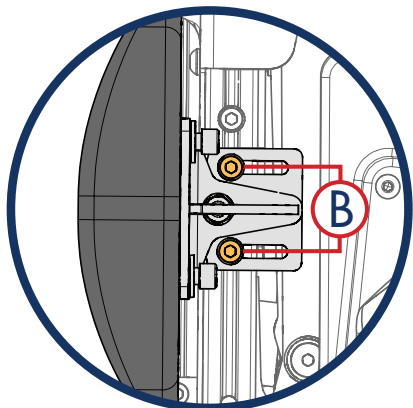

ADJUSTING THE ARTICULATING RANGE

The power elevating center mount is equipped with parallelogram-type mechanism which is set at the factory to articulate by 7¼" (185 mm). At this setting, the bolts are in position "2", as shown in the lower diagram below.

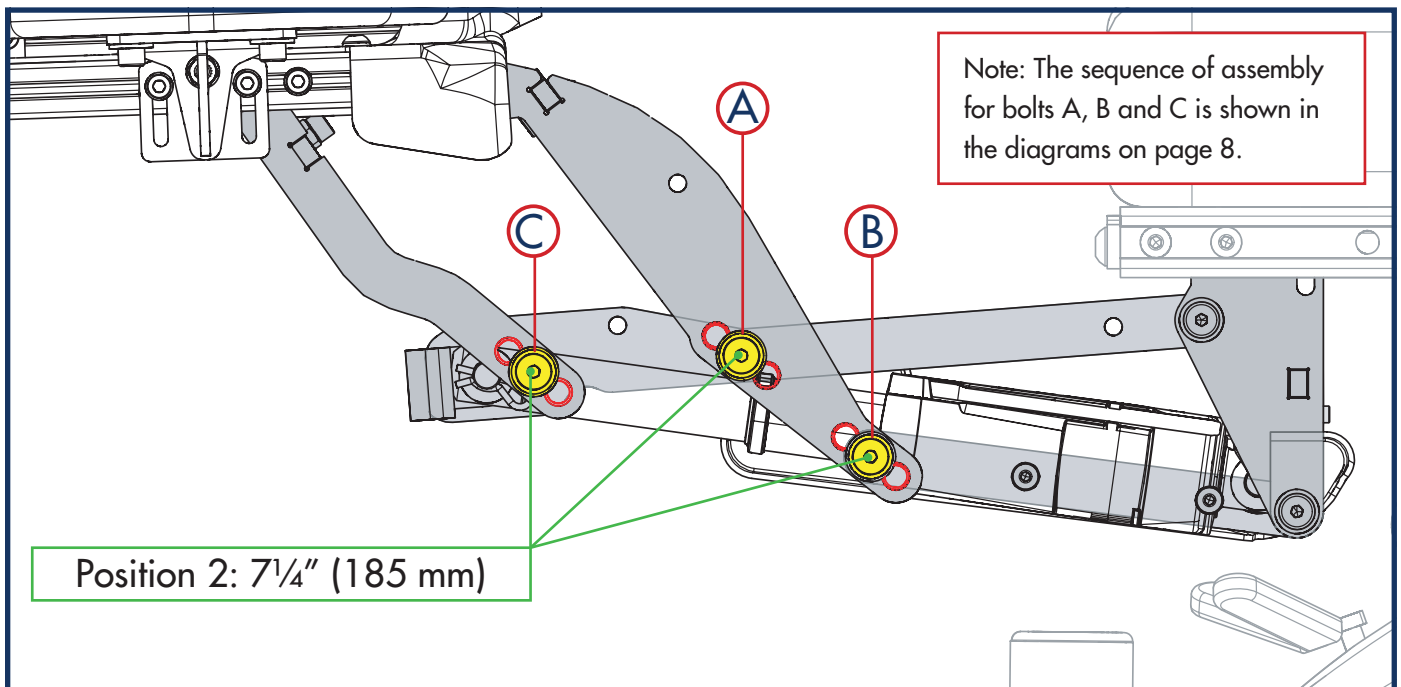
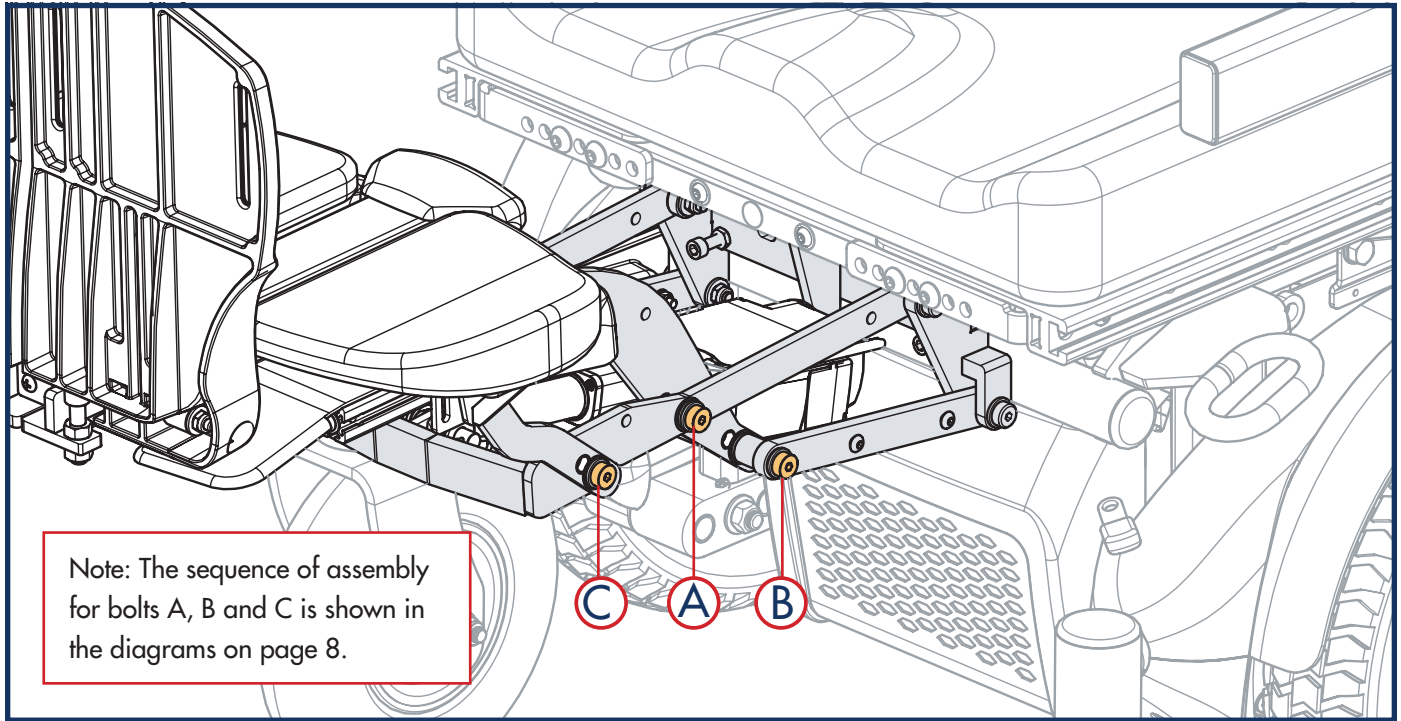

Adjusting at a **shorter** articulating range of 6½" (165 mm)

Extend the legrest in a horizontal position in order to have access to all bolts, as shown in the diagram below, then set the wheelchair's power to OFF.

Using a 3 mm Allen key and an 8 mm wrench, remove the plastic cover on both sides of the legrest.

Using a 4 mm Allen key and a 10 mm wrench, loosen nuts from bolts "A" on both left and right sides. Before completely removing bolts, provide adequate support to the legrest in order to prevent it from dropping. Remove bolts on both sides.

Pay special attention to the positioning of each washer. To ensure proper functioning of articulations, the sequence must remain the same when reassembling washers (Refer to the diagrams on page 8).

Reinsert bolt "A" in position "1" on each side and tighten moderately.

Using the same tools, loosen nuts from bolts "C" on both left and right sides. Always respecting the sequential positioning of each washers (Refer to the diagrams on page 8), remove one bolt at a time while supporting "D".

Still using the same tools, loosen nuts from bolts "B". Remove bolts (one side at a time) from position "2" while supporting the legrest. Reinsert bolt "B" (one side at a time) in position "1" (as shown in the diagram) always respecting the washers' sequence (Refer to the diagrams on page 8). Tighten bolts on each side moderately.

Reinsert bolt "C" (one side at a time) in position "1" while respecting the sequential positioning of each washers (Refer to the diagrams on page 8). Tighten bolts moderately.

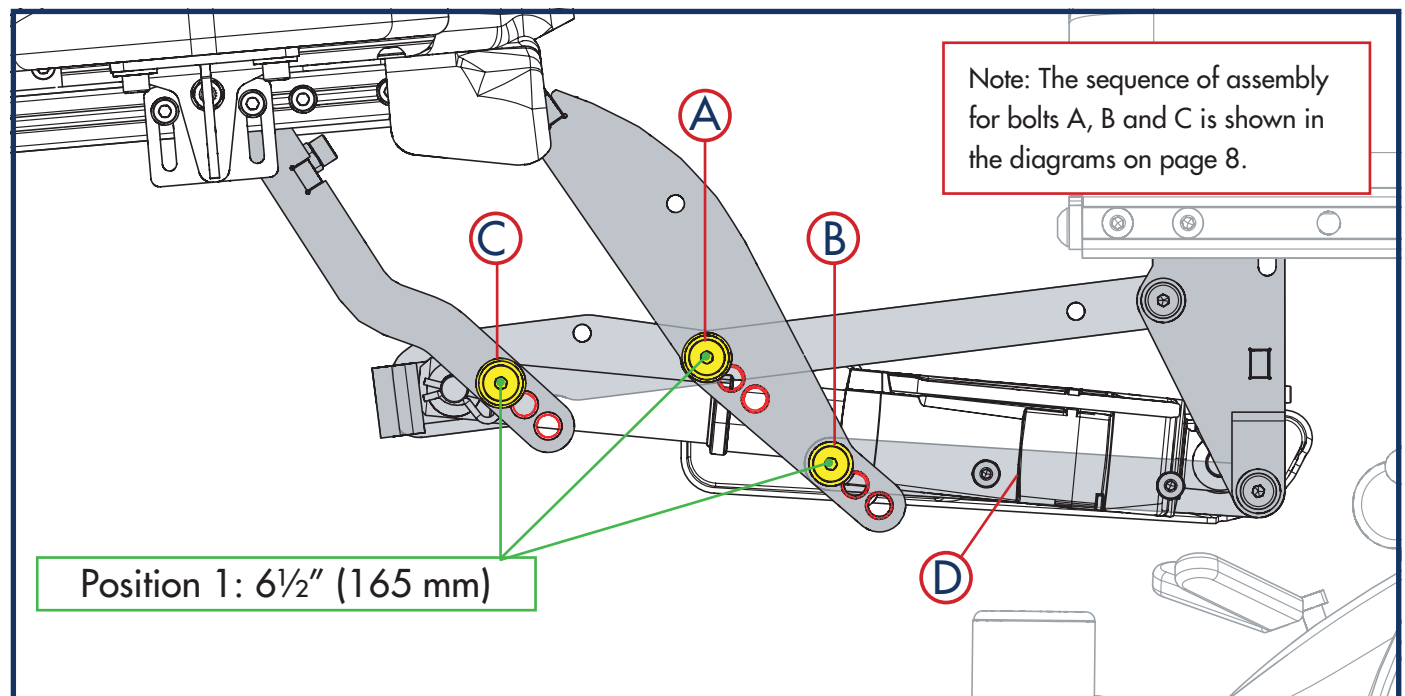

Adjusting at a **longer** articulating range of 8" (205 mm)

Extend the legrest in a horizontal position in order to have access to all bolts, as shown in the diagram below, then set the wheelchair's power to OFF.

Using a 4 mm Allen key and a 10 mm wrench, remove the plastic cover on both sides of the legrest.

Using a 4 mm Allen key and a 10 mm wrench, loosen nuts from bolts "A" on both left and right sides. Before completely removing bolts, provide adequate support to the legrest in order to prevent it from dropping. Remove bolts on both sides.

Pay special attention to the positioning of each washer. To ensure proper functioning of articulations, the sequence must remain the same when reassembling washers (Refer to the diagrams on page 8).

Reinsert bolt "A" in position "3" on each side and tighten moderately.

Using the same tools, loosen nuts from bolts "C" on both left and right sides. Always respecting the sequential positioning of each washers (Refer to the diagrams on page 8), remove one bolt at a time while supporting "D".

Still using the same tools, loosen nuts from bolts "B". Remove bolts (one side at a time) from position "2" while supporting the legrest. Reinsert bolt "B" (one side at a time) in position "3" (as shown in the diagram) always respecting the washers' sequence (Refer to the diagrams on page 8). Tighten bolts on each side moderately.

Reinsert bolt "C" (one side at a time) in position "3" while respecting the sequential positioning of each washers (Refer to the diagrams on page 8). Tighten bolts moderately.

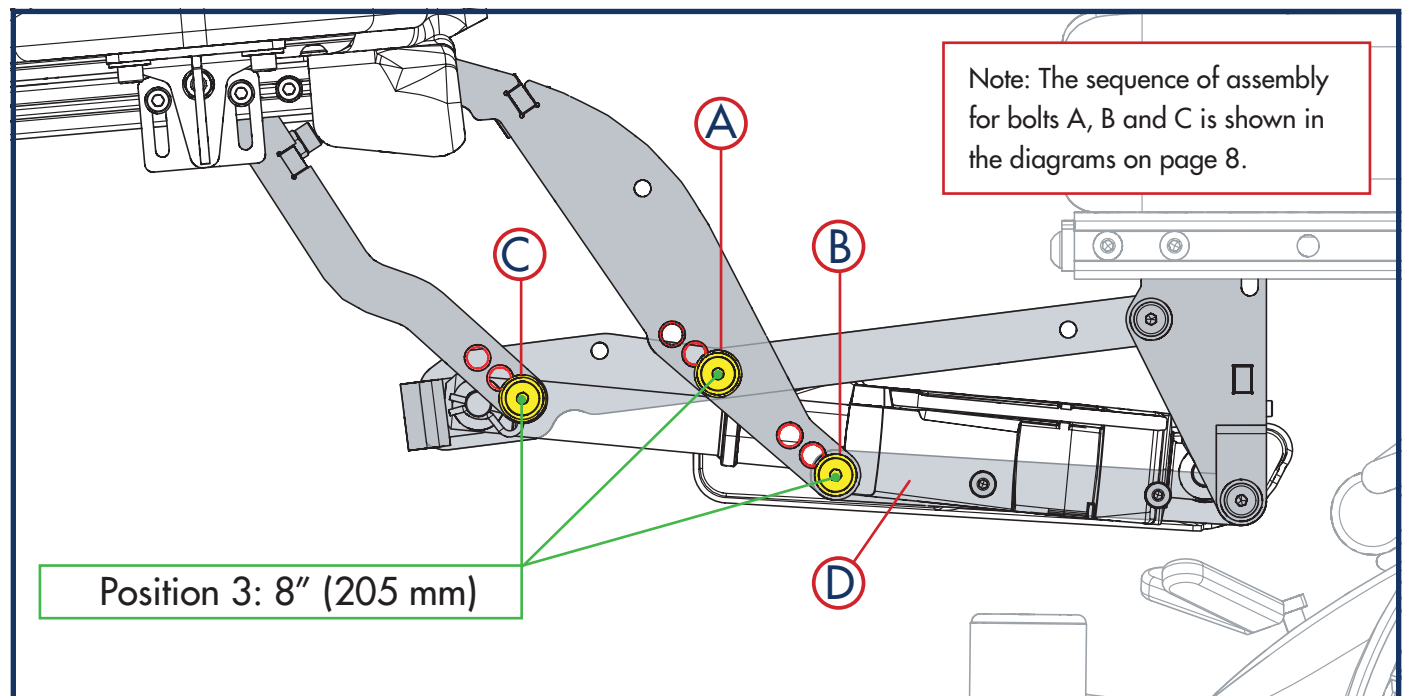

Sequential assembly of bolt

A

BOLT SIDE:

- a) Shoulder bolt (shorter)
- b) 2 metal washers
- c) 1 plastic washer

NUT SIDE:

- d) Nut
- e) 1 metal washer
- f) 1 plastic washer

Sequential assembly of bolt

B

BOLT SIDE:

- a) Shoulder bolt (longer)
- b) 1 metal washer

NUT SIDE:

- c) Nut
- d) 1 metal washer
- e) 1 plastic washer

BETWEEN BOTH STEEL FLAT BARS

- f) 1 plastic washer

Sequential assembly of bolt

C

BOLT SIDE:

- a) Shoulder bolt (shorter)
- b) 1 metal washer
- c) 1 plastic washer

NUT SIDE:

- d) Nut
- e) 2 metal washers
- f) 1 plastic washer

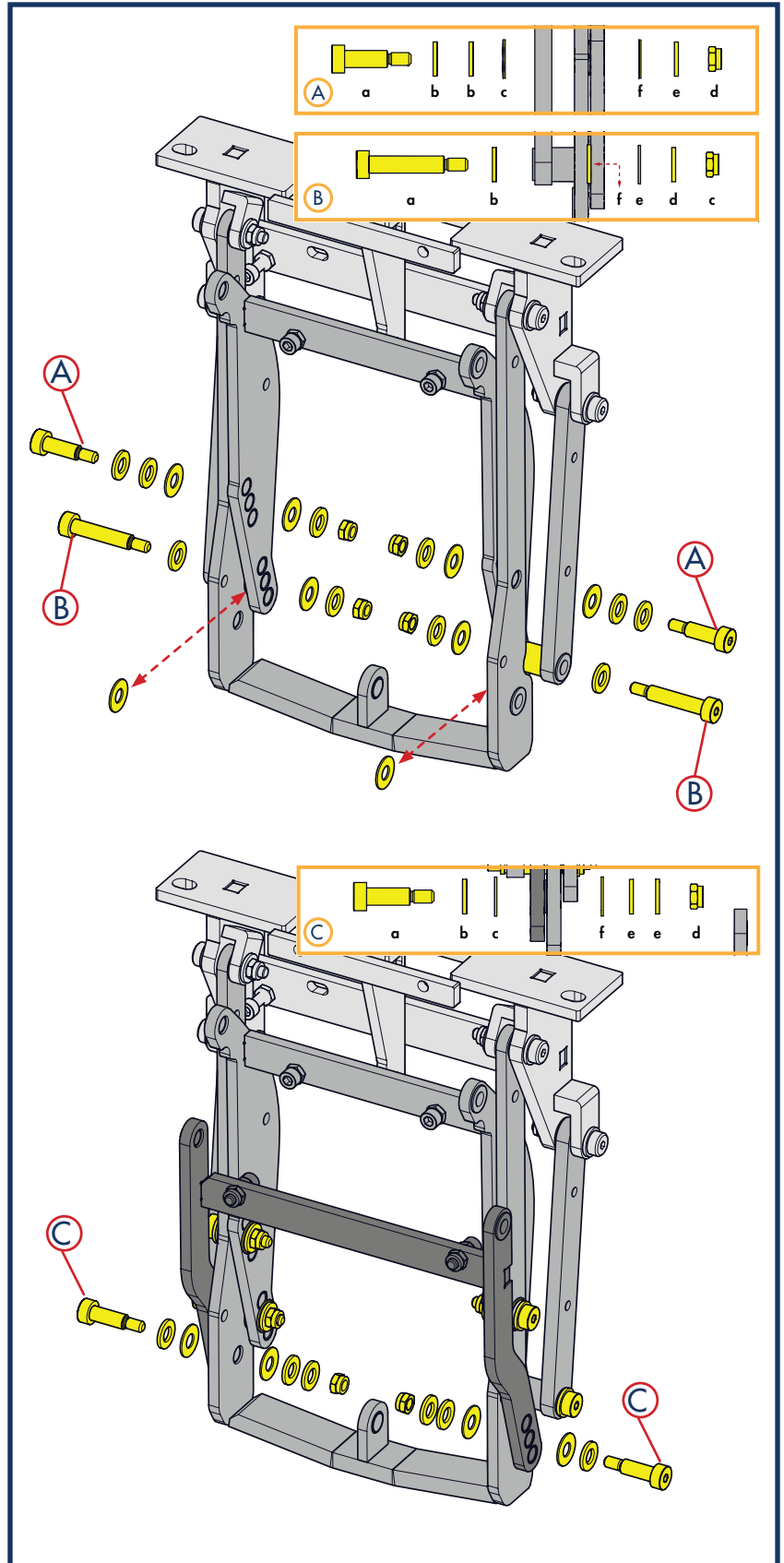

REPLACING THE ACTUATOR

Removing the current actuator:

When removing the actuator, start at the bottom of the legrest module, then the top.

Using a screwdriver or pliers, pull the hitch pin **(B)** from the clevis pin **(A)** that holds the actuator **at the bottom** of the module. Remove the clevis pin **(A)** to release the actuator.

The legrest module can now be extended.

Warning:

Handle the legrest module with care to avoid pinching your fingers or hand.

To release the actuator from the **top** of the module, pull the hitch pin **(D)** from the clevis pin **(C)** and remove the clevis pin **(C)**. Unplug the actuator and set aside.

Installing the new actuator:

Note :

When handling the actuator, the shaft should not be screwed or unscrewed as this will alter its stroke setting.

When installing the new actuator, start at the top of the legrest module, then the bottom.

Ensure that the actuator has its motor in an upward position toward the left of the wheelchair (when facing the wheelchair).

To attach the actuator at the **top**, align the shaft's mounting holes with the top bracket, insert the clevis pin **(C)** to hold it up and secure it with the hitch pin **(D)**.

Similarly, align the **bottom** mounting holes with the bottom bracket, insert the clevis pin **(A)** followed by the hitch pin **(B)**. Reconnect the actuator and using a cable tie, secure its wire underneath the seat pan.

